

Major Quality. Major Value.
Major Savings.

10605/MAJ
BuyLine 4516



Wire Mesh Lockers



Wire Mesh Partitions

**Powder
Coated
to Last**

MAJOR PARTITIONS

We Major in *Customer Satisfaction*

TOLL FREE 1.866.638.4761

www.majorpartitions.ca

MAJOR PARTITIONS

WIRE MESH

COMPONENTS:

1 PANELS

Shall be electric welded mesh 2" x 2" x 1/8" (10ga .135 wire) (50mm x 50mm x 3.2 mm wire) framed by 1 1/4" x 1 1/4" x 12ga (.105) (32mm x 32mm x 3mm) formed angles calibrated at 50,000 psi for extra strength. All panels shall be fastened to post by using 1/4" x 2 3/4" cadmium plated bolts and nuts.

2 SWING DOORS

All doors whether single or double shall consist of electric welded mesh 2" x 2" x 1/8" (10ga .135 wire) (50mm x 50mm x 32mm wire) framed by 1 1/4" x 1 1/4" x 12ga (32 mm x 32 mm x 3 mm) formed angle calibrated at 50,000 psi for extra strength. All doors have as reinforcement 1/2" (12.5mm) diameter rod from center to corners with all hinges padlock hasp.

3 SLIDING DOORS

Sliding doors shall be made of same materials as the panels and swing doors. Sliding doors are space efficient due to the fact that they slide parallel to partition walls. Doors shall be supported by two sets of 2" rollers (4 wheels per set) in a 2" x 2 1/2" track made of formed 14ga steel. Stoppers, hasps and floor guide will be supplied for installation.

4 DUTCH DOORS

AND GUILLOTINE SERVICE WICKETS
Dutch doors and guillotine service wickets shall be composed of before mentioned materials. Dutch door shall be separated in the middle by a shelf composed of 10ga sheet metal. They allow direct access in the secure area and can be used as a service wicket. Guillotine service wickets shall be made of panels with pre-designed access windows. One shelf will be supplied for installation with each wicket. They do not allow direct access to secure area and are used for service purpose only.

www.majorpartitions.ca

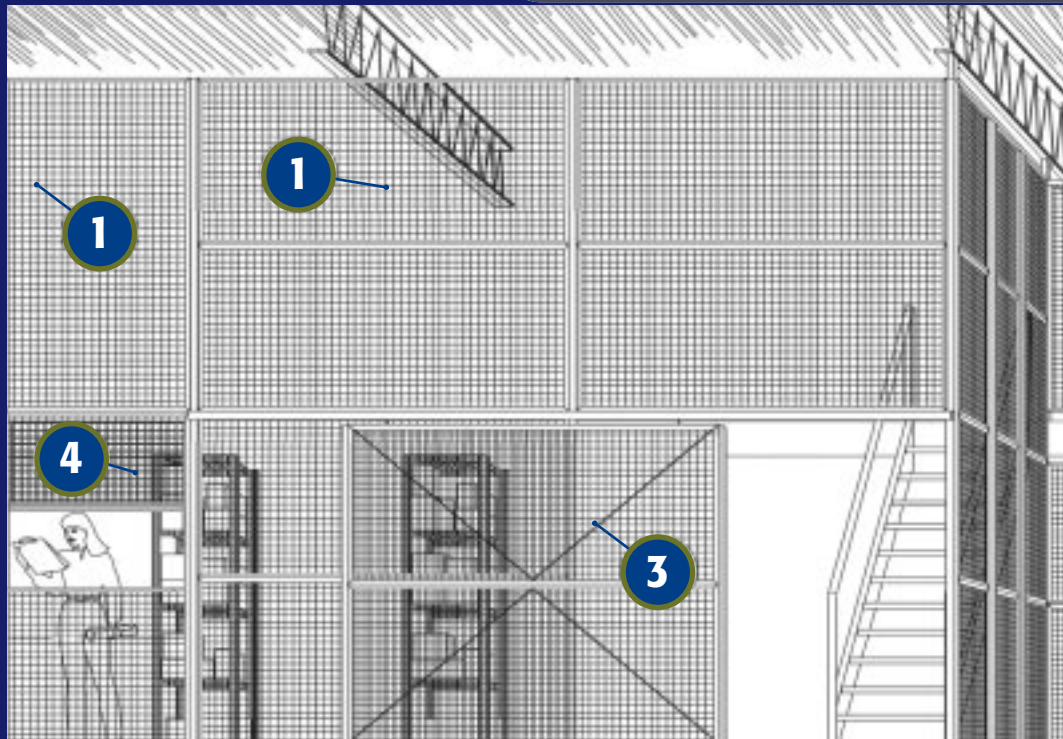

WIRE MESH

WIRE MESH LOCKERS

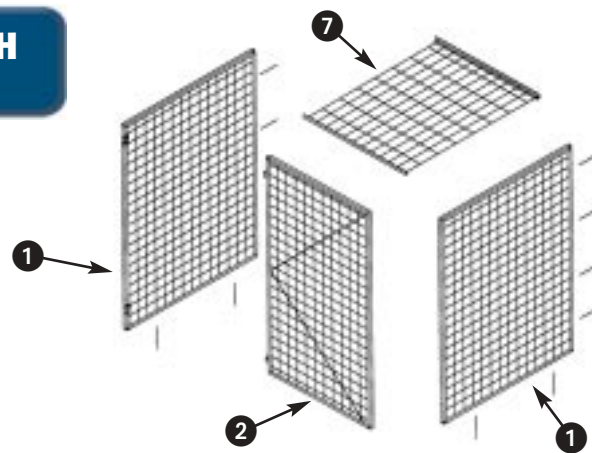

HEAVY DUTY WIRE MESH SINGLE TIER LOCKERS

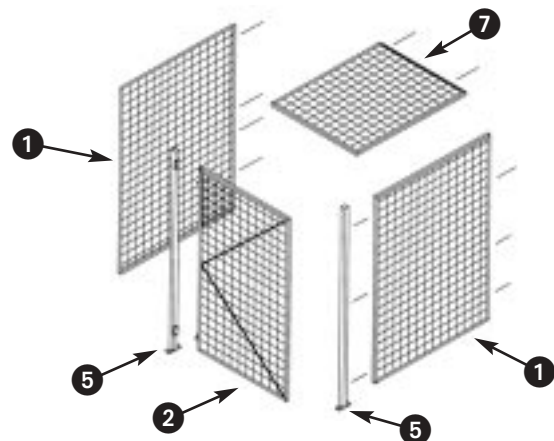

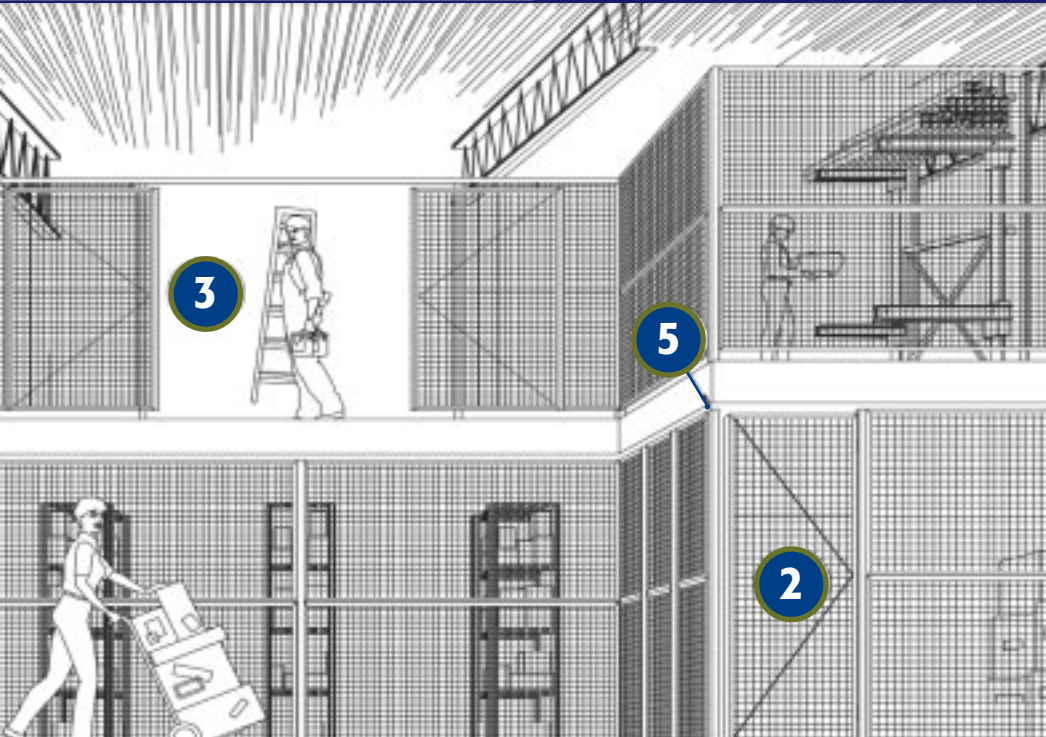

5 POSTS

Posts shall be 2" x 2" x 16g (50 x 50 x 2mm) square tubular steel welded to a base plate 2" x 6" x 1/4" (50 x 150 x 6.4mm) designed to fasten to floor using two 2 3/4" x 3/8" anchor bolts per post. Post top extensions will be supplied when necessary to anchor the posts to ceilings.

PARTITION ROOFS

Roofs shall be made of same materials as panels. Roof panels shall be attached together using 1/4" x 3/4" bolts and nuts to form a pre-engineered layout. Roofs shall be attached to partition structure using 2" x 2" x 16g (50 x 50 x 2mm) square tubing sleeved to inter-connect with posts. In order to permit larger spans for roofs, pre-designed trusses shall be supplied to accommodate distances.

7 LOCKER TOPS

Shall be electric welded mesh 2" x 2" x 1/8" or (2" x 4" x 1/8") (10ga .135 wire) (50mm x 50mm x 3.2mm wire) framed by 1 1/4" x 1 1/4" x 12ga (.105) (32mm x 32mm x 3mm) formed angles calibrated at 50,000 psi for extra strength.

8 LOCKER SHELVES

Shall be constructed of 16g sheet metal welded in an angle frame of 1 1/4" x 1 1/4" x 12g (32mm x 32mm x 3mm) option of wire mesh may be used and adjustable shelves available.

9 LOCKER TUBING ATTACHMENT

(FOR DOUBLE TIER)
All panels shall be fastened to tubing by using 1/4" x 2 2/3" cadmium plated bolts and nuts, tubing shall be 2" x 2" x 16ga (50mm x 50mm x 2mm).

LOCKERS

HEAVY DUTY WIRE MESH DOUBLE TIER LOCKERS

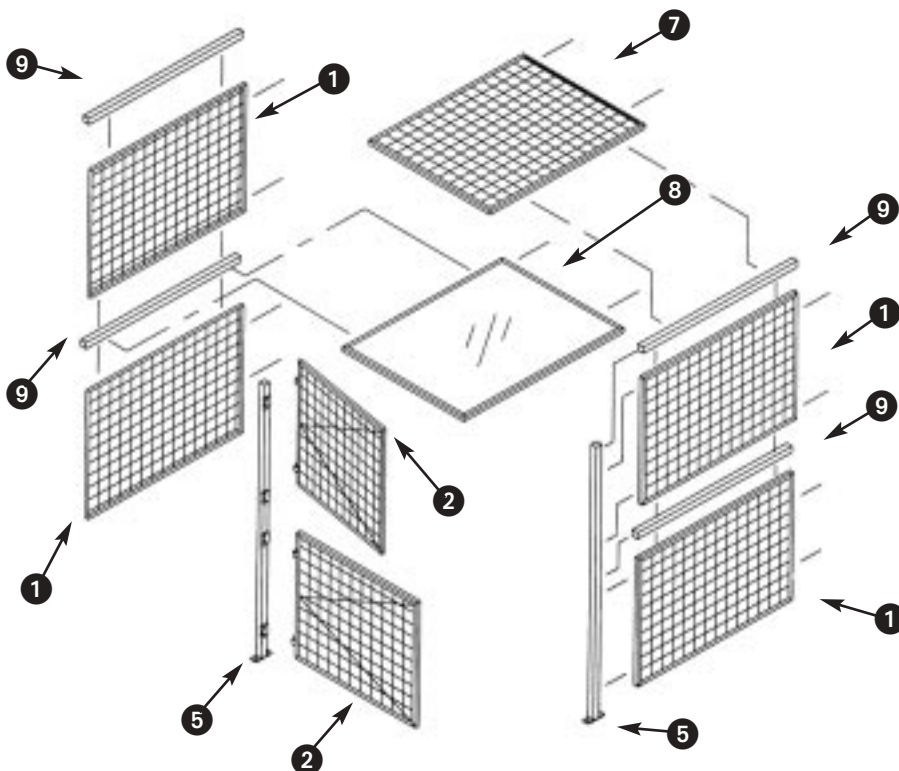

THREE PART SPECS

MAJOR STORAGE LOCKERS SHALL BE STEEL, WITH ALL WELDED COMPONENTS AS PRODUCED BY MAJOR PARTITIONS LTD. QUANTITIES, SIZES AND ARRANGEMENTS SHALL BE SHOWN ON DRAWINGS

WIRE MESH PARTITIONS

PART 1 GENERAL

System description

Provide wire mesh partitions (lockers) and necessary accessories as called for on the drawings and as specified herein

Submittals

Submit shop drawings in accordance with sections Submit samples of materials to consultant upon request

Warranty

The supplier shall warrant the wire mesh partitions (lockers) to be free from manufacturing defects for a period of 1 year

Fabrication

Shop fabricate wire mesh partitions (lockers) and accessories. Where necessary take site measurements for areas where partitions are to be located and fabricate to suit dimensions

PART 2 PRODUCT

Panels

Panels shall be 10g wire spot welded into 2" x 2" squares (50mm x 50mm x 3.2mm wire) welded into an angle frame of 1/4" x 1/4" x 12" angle (32mm x 32mm x 3mm) welded at every 8 inches. Panels 3 to 6 feet long receive 1/4" x 3/16" stiffener, longer panels receive 2 stiffeners dividing the panel in equal sections. All panels shall be fastened to posts by using 1/4" x 2 3/4" cadmium bolts and nuts.

Swing doors

Swing doors shall be made of the same material and method as panels with an added 1/2" rod (12.5mm) from center to corners. Doors shall be equipped with padlock lugs (option cylinder lock), door strikes and 1 1/2" pair of hinges.

Sliding doors

Sliding doors shall be made of the same material and method as panels reinforced with 1/4" (32mm) square tubing. Doors shall be supported with 2 sets of trolleys in a 2" x 2 1/2" track x 14g (50 x 62mm). Doors shall be equipped with stoppers, hasps and guide (option cylinder lock).

Posts

Posts shall be 2" x 2" x 16g (50mm x 50mm x 2mm) square tubular steel welded to a base plate 2" x 6" x 1/4" (50mm x 150mm x 6.4mm) using two 2 3/4" x 3/8" anchor bolts

Finish

Baked grey powder coat over phosphate treated steel

PART 3 EXECUTION

Installation

Install in strict accordance with reviewed shop drawings and manufacturer's instruction. Provide all anchorage devices and attachments as required. Adjust hinges of doors to operate properly. Secure screens rigidly in place.

HEAVY DUTY WIRE MESH LOCKERS

PART 1 GENERAL

Same as wire partitions

PART 2 PRODUCT

Panels

Panels shall be 10g wire spot welded into 2" x 2" squares (50mm x 50mm x 3.2mm wire) welded into an angle frame of 1/4" x 1/4" x 12" angle (32mm x 32mm x 3mm) welded at every 8 inches. All panels shall be fastened to posts by using 1/4" x 2 3/4" cadmium bolts and nuts.

Swing Doors

Swing doors shall be made of the same materials and method as panels with an added 1/2" rod (12.5mm) from center to corners. Doors shall be equipped with padlock lugs, door strikes and 1 1/2" pair of hinges.

Tops

Tops shall be 10g wire spot welded into 2" x 2" squares (50mm x 50mm x 3.2mm wire) welded into an angle frame of 1/4" x 1/4" x 12" angle (32mm x 32mm x 3mm) welded at every 8 inches. All panels shall be fastened to Tubes by using 1/4" x 2 3/4" cadmium bolts and nuts.

Posts

Posts shall be 2" x 2" x 16g (50mm x 50mm x 2mm) square tubular steel welded to a base plate 2" x 6" x 1/4" (50mm x 150mm x 6.4mm) using two 2 3/4" x 3/8" anchor bolts.

Tubing attachments (double tier)

All panels shall be fastened to tubing using 1/4" x 2 3/4" cadmium palted bolts and nuts, tubing shall be 2" x 2" x 16g (50mm x 50mm x 2mm) square tubular steel.

Shelves (double tier)

Shall be constructed of 16 g sheet metal welded in an angle frame of 1/4" x 1/4" x 12 angle (32mm x 32mm x 3mm) welded at every 8 inches. All panels shall be fastened to tubes by using 1/4" x 2 3/4" cadmium bolts and nuts.

Finish

Baked grey powder coat over phosphate treated steel

PART 3 EXECUTION

Same as wire partitions

WIRE MESH LOCKERS

PART 1 GENERAL

Same as wire partitions

PART 2 PRODUCT

Panels

Panels shall be 10g wire spot welded into 2" x 2" squares (50mm x 50mm x 3.2mm wire) welded into an angle frame of 1/4" x 1/4" x 12" angle (32mm x 32mm x 3mm) welded at every 8 inches. All panels shall be fastened to floor using 1/4" x 1 1/4" drive nails anchor.

Swing doors

Swing doors shall be made of the same material and method as panels with an added 1/2" rod (12.5mm) from center to corners. Doors shall be equipped with padlock lugs, door strikes and 1 1/2" pair of hinges.

Tops

Shall be electric welded mesh 2" x 4" x 1/8" (50mm x 50mm x 3.2mm wire) Framed in 1/4" x 1/4" angle 12g (32mm x 32mm x 3mm). These tops are sized to cover two to three lockers.

Finish

Baked grey powder coat over phosphate treated steel

PART 3 EXECUTION

Same as wire partitions

SEE US IN     

MAJOR PARTITIONS

We Major in Customer Satisfaction

• 45 State Street, Montpelier, VT 05602 USA
Tel.: 1(866)638-4761 Fax: (450)638-2403

• 5014 New Street, Unit 2, Suite 305
Burlington, Ontario L7L 6E8
Tel.: (905) 332-3411 Fax: (905) 332-7252

Toll free 1.866.638.4761

• 10 Liberté, #9, Candiac, Québec J5R 3X8
Tel.: (450) 638-4071 Fax: (450) 638-2403

• 6200 McKay Ave, Suite 141-917, Burnaby, B.C. V5H 4M9
Tel.: (403) 264-5044 Fax: (403) 264-5054

www.majorpartitions.ca

E-mail: wire@majorpartitions.ca